

POWER-UP/GRAVITY-DOWN LIFT GATE PUMP ASSEMBLIES

Replacement parts available for each unit.

FENNER (SPX) STYLE UNITS

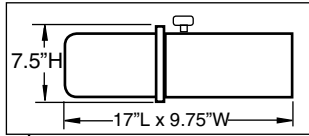

48-205

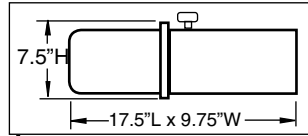

48-205A

48-205 - OEM Push Button Power Pack w/3 quart reservoir

Electric unit for push-button operation; used on many liftgates including Del America, Waltco (30195000).

48-205A - Same as 48-205 with heavy duty motor.

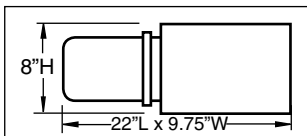
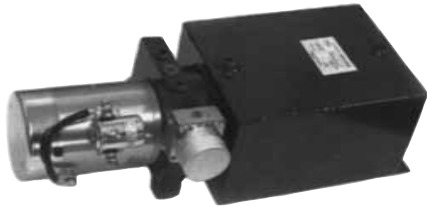

48-205B

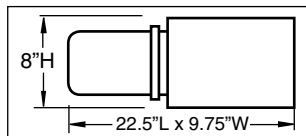

48-205C

48-205B - Same as 48-205 except with square 2.5 gallon reservoir.

48-205C - Same as 48-205B with 2.5 gallon reservoir and with 4 holes in reservoir. Extra holes used for hand pump.

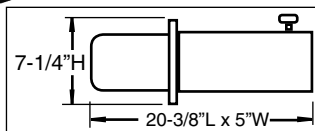

48-210

48-210

OEM Push Button Power Pack w/3 quart reservoir

Replacement for Maxon Corp. (250100) and many others. Very popular for universal replacement. Pressure set to 2500 psi - adj. Prestolite solenoid, two wires for drain solenoid.

12" long reservoir with breather and extra port for return line.

48-210A - Same as 48-210 except with heavy-duty motor and 2.5 gallon square reservoir.

MONARCH STYLE UNITS

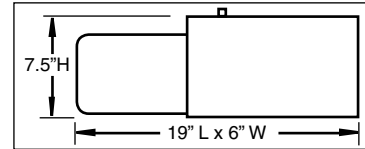

48-215 - OEM Push Button Power Pack with 3 quart reservoir. 10" long reservoir, fits Del America and many others.

48-215A - Same as 48-215 except with heavy duty motor.

48-215B - Same as 48-215 except w/2.5 gallon reservoir.

48-215C - Same as 48-215B with 2.5 gallon reservoir except with heavy duty motor.



48-217 Same as 48-215 except with plastic reservoir and with side discharge and mounting.

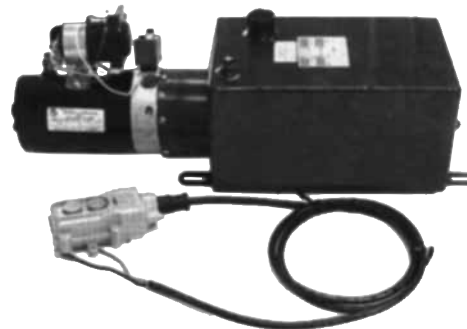

3000PSI

MADE FOR DUMP UNITS

48-215D - Power Pack with 2.5 Gallon Reservoir and Remote Push Button Switch. 3000 psi, reservoir 6" x 7" x 12" (GC42). Made for dump units.

LIFT GATE

Motors for Thieman, Anthony, Maxon, Waltco, Leyman and Others

48-415

OEM Fenner, Regular Duty Yellow 12V Splined Shaft - CW, Fits Waltco (70392900), Maxon (222423), Anthony (A150265), Venco (13850), DelAmerica (25169), Tommy (42 Fenner), Fenner (1185AC & 1787AC)



48-415 / 48-417

48-417

Same as 48-415 but with Thermal Protection.

48-435

Same as 48-415 but economy value line replacement motor.



48-435

48-420

Regular Duty Replacement with Tang Shaft fits Prestolite MHN CCW Rotation used on Thieman, Anthony and others.



48-420

48-425

Same as 48-420 except Clockwise



48-425

48-430

Winch Motor, Replaces Ramsey #458001 & Prestolite# MBJ-4407 & Desert T-200 (not shown)



48-440

48-440

Heavy Duty Replacement for Larger Tailgates. (9) Spline, CW.

Fits: Maxon (226578), Waltco (70392800 & 70391100) Leyman (P46340), Venco (13850), DelAmerica (25163), Fenner (1789AC & 2578AC)



48-445 / 48-446

48-445

Heavy Duty Liftgate motor, Splined shaft, CW. Fits Waltco (70392800 & 70391100), Maxon (226578), Venco (13850), DelAmerica (25163), Leyman (P46340), Fenner (1789AC & 2578AC)

48-446

Same as 48-445 but with Thermal Protection.



48-447

48-447

12V Splined Shaft Motor - CW, Heavy Duty, 2 Post 9 Spline Shaft



48-448

48-448

12V Splined Shaft Motor - Bi-Rotational, Ideal for Power Down Applications



48-450

48-450

Level Lift Motor, Models Waltco BZ-15 and BZ-20, Replaces Waltco 70093632

48-451

12V OE Motor fits HPI



48-451

48-452

12V Very Heavy Duty 5" Motor. Fits Leyman (P33592), Prestolite (ML4355)



48-452

48-453

12V Tang Motor fits Lee Pump

48-455

Regular Duty 3" Motor, CCW. Side Post. Replaces: DelAmerica 16399, Monarch 8110, Braun, Prestolite MKW4011, Eagle 1330185



48-453

48-456

12V Regular Duty Motor fits Smith 2KW (504377)

48-457

12V Heavy Duty Motor fits Smith 3KW (504744)

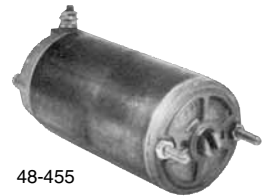

48-455

48-460

3" OEM Replacement Motor, Top Post Iskra brand motor. Replaces: DelAmerica 16399, Leyman P33939, Thieman 4423720, Waltco 70092401



48-456/457

48-465

Heavy Duty, Prestolite Motor, CCW Fits: Anthony A150018M, Leyman LH150018, Thieman 4421721, Eagle 1330180, Tommy 42 Monarch, Waltco 70092312, Maxon 223740, DelAmerica 20415, Monarch 8111 or 8112, Barnes MDY7027

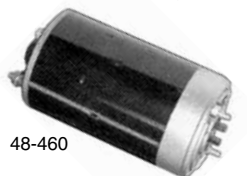

48-460

48-466

12V Heavy Duty Motor - CCW. Fits Monarch (8100, MMY), Waltco (70091739), Thieman (4422590), Leyman (MMY4001), Prestolite (MFX4002)



48-465

48-467

12V Heavy Duty Motor - CCW. Fits Maxon (229272, 250093, 39200398), Leyman (P33818)



48-466/467

48-470 **NEW**

12V Liftgate Motor with tang shaft Fits Maxon (250100)



48-470

NEW

Monarch Reservoirs



Monarch Reservoirs

- 48-710** 4-1/2" x 13", Plastic reservoir.
- 48-711** 4-1/2" x 8", Plastic reservoir.
- 48-712** 4-1/2" x 11", Metal reservoir.
- 48-713** 4-1/2" x 12", Metal reservoir, 2 holes.
- 48-714** 4-1/2" x 12", Metal reservoir, 1 hole.
- 48-715** 4-1/2" x 6" x 9", Metal reservoir.
- 48-716** 6" x 7" x 15", Metal reservoir, 2-1/2 gallon capacity.
- 48-717** 4-1/2" x 8", Metal reservoir, 2 holes.
- 48-718** 4-1/2" x 8", Metal reservoir, 1 hole.

Fenner Reservoirs

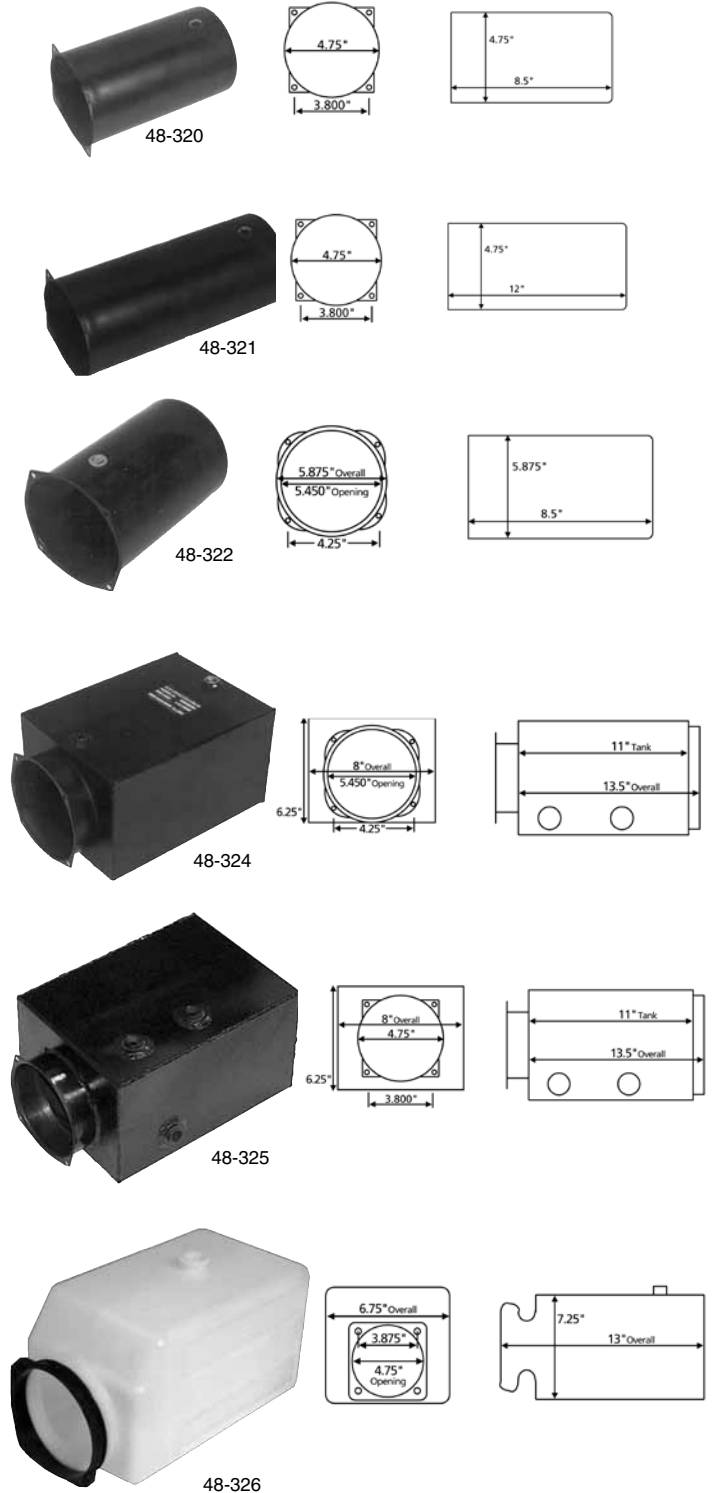

Fenner Reservoirs

- 48-320** 4-3/4" x 8-1/2", 2 Quart capacity reservoir.
- 48-321** 4-3/4" x 12", 3 Quart capacity reservoir, 2 holes.
- 48-322** 5-7/8" x 8-1/2", 3 Quart capacity reservoir.
- 48-324** 6-1/4" x 8" x 13-1/2", 2-1/2 Gallon capacity reservoir.
Has extra port for hand pump.
- 48-325** 6-1/4" x 8" x 13-1/2", 2-1/2 Gallon capacity reservoir.
- 48-326** 6-3/4" x 7-1/4" x 13", 2-1/2 Gallon capacity reservoir.

LIFT GATE

Single Pole Cable and Plug



- 43-080** - 12 foot Tailgate Lift Cable
- 43-082** - 15 foot Tailgate Lift Cable
- 43-083** - Single Pole Socket
- 43-084** - Single Pole Plug End

Dual Pole Cable and Plug



- 43-091** - 12.5 foot Tailgate Lift Cable
4 ga. copper, rated 200 amps
- 43-092** - Dual Pole Plug and Socket
- 43-093** - Dual Pole Socket
- 43-094** - Dual Pole Plug

4-Pole Plug, Cable & Socket



- 48-060** - 4-Pole plug with cable clamp and spring protector
- 48-062** - 3 Conductor Retractable Cable, 16 Ga., 4 to 20 ft.
- 47-218** - 4 Conductor Straight Cable, 14 Ga., 100' Spool
- 48-061** - 4 pole socket

Starter Bracket Kits

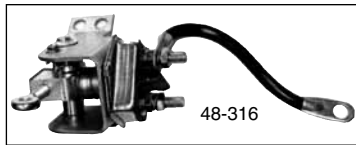
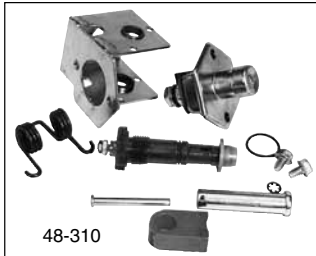

- 48-310** Starter bracket kit that fits Maxon, Waltco & Venco
- 48-312** Starter bracket kit, same as 48-310 but without switch, cap & stem
- 48-314** Starter bracket kit with canister switch
- 48-315** Starter bracket kit with canister switch & strap that fits Thieman & Waltco
- 48-316** Starter bracket kit with start switch & terminal strap that fits Eagle & Tommy

Power Unit to Battery Cable



- 47-240** - 1/0 Ga. Black Wire, 25 ft Spool
- AV-12770** - Top Stud Copper Battery Ring, Crimp Type, Stud Size: 3/8", 2" overall length. 5 per box.

Replacement Solenoids

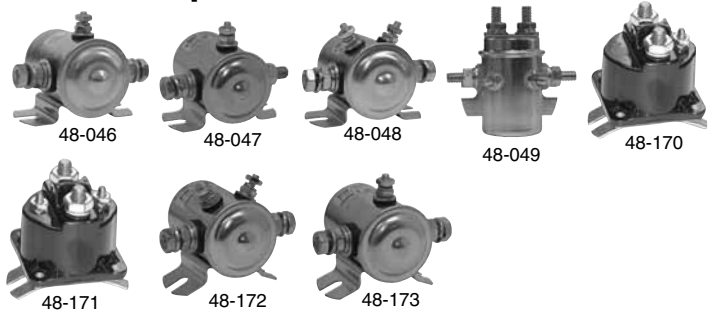

- 48-046** 3 Post, positive to excite, grounded solenoid with flat base.
- 48-047** 3 Post, negative to excite, insulated solenoid with flat base.
- 48-048** 4 Post insulated solenoid with flat base
- 48-049** 6 Post winch solenoid. Used on Ramsey Winches and others.
- 48-170** 3 post, positive, grounded Prestolite solenoid with curved base.
- 48-171** 4 post, insulated, Prestolite solenoid with curved base.
- 48-172** 4 post, insulated solenoid with curved base.
- 48-173** 3 post, positive to excite, grounded solenoid with curved base.

Switches

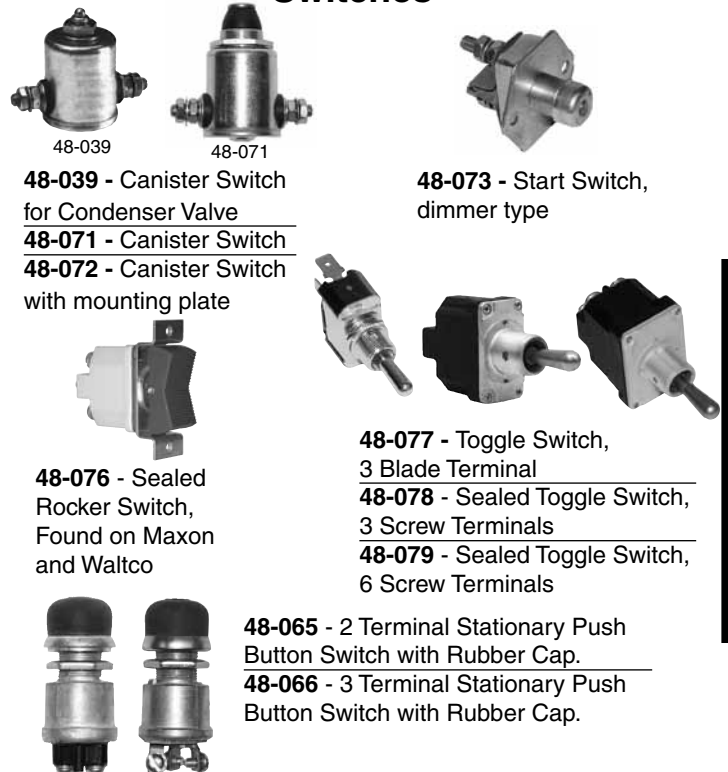

- 48-039** - Canister Switch for Condenser Valve
- 48-071** - Canister Switch
- 48-072** - Canister Switch with mounting plate
- 48-073** - Start Switch, dimmer type
- 48-076** - Sealed Rocker Switch, Found on Maxon and Waltco
- 48-077** - Toggle Switch, 3 Blade Terminal
- 48-078** - Sealed Toggle Switch, 3 Screw Terminals
- 48-079** - Sealed Toggle Switch, 6 Screw Terminals
- 48-065** - 2 Terminal Stationary Push Button Switch with Rubber Cap.
- 48-066** - 3 Terminal Stationary Push Button Switch with Rubber Cap.

- 48-074** - Cut-Off Safety Switch. Replaces Anthony: A150031,



For Circuit Breakers See Page 207

Remote Controls

- Rugged A.B.S. • Sealed to I.P. 65
- Two magnets for easy mounting • 10 ft. cord
- Interlocked to prevent simultaneous operation



48-080
48-082



48-085
48-084

- 48-080** 4-Wire, dual action w/10 ft. cable
- 48-081** 4-Wire, wired to 4-conductor plug
- 48-082** 3-Wire control w/10ft. cable
- 48-083** 3-Wire control, wired to 4-conductor plug
- 48-084** Control & holster, gravity down
- 48-085** Holster

Weatherproof Remote Controls



48-091

48-092
48-096

- 48-091** Single or double pole
- 48-092** Wired with 10 ft. 16/3 cord
- 48-093** Wired with 16/3 cord & 4 cond male plug
- 48-094** Wired with 16/3 retractile cord
- 48-095** Wired with 16/3 retractile cord & 4 conductor plug
- 48-096** Wired with 10 ft. 16/4 cord
- 48-097** Wired with 16/4 cord & 4 conductor male plug
- 48-098** Wired with 16/4 retractile cord
- 48-099** Wired with 16/4 retractile cord & 4 conductor male plug

Permanent Mount Push Button or Toggle Box

48-050
Push Button Control Box,
with 3 wires, gray.

48-052
Push Button Control Box,
without wires, gray

48-054
Toggle Control Box, without
wire ready for mounting
toggle switch is 3 terminal

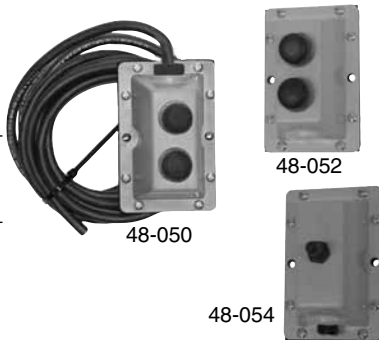

48-050

48-052

48-054

Hand Held Push Button Switch



48-068

48-069

48-070

48-075

- 48-068** - Hand held push button switch with retractable cord
- 48-069** - Hand held push button switch with 10 ft. straight cord, Orange.

- 48-070** - Pistol Grip Toggle Remote, 3-blade terminals.
- 48-075** - Pistol Grip Toggle Remote, wired with 3 cord, 16 ga. wire with 4 conductor plug.



This switch replaces old style switch.

48-086 - Raise/lower switch, fits Waltco (10099300)

Couplers

- Connects Pump to Motor

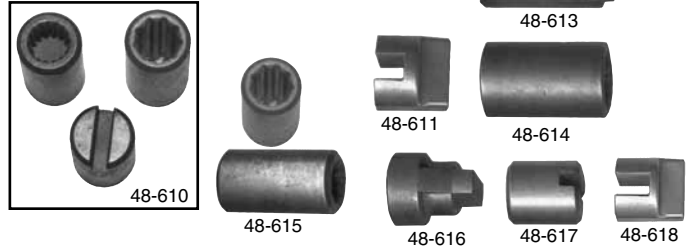

- 48-610** Coupler kit, includes: 48-614, 48-615 & 48-617
- 48-611** Tang to tang, (.570"L)
- 48-613** Male tang to 9 spline, (1.435"L)
- 48-614** 9 spline to 16 spline, (1.16"L)
- 48-615** 9 spline to 9 spline, (1.265"L)
- 48-616** Male tang to 9 spline, (.880"L)
- 48-617** 9 spline to female tang, (.795"L)
- 48-618** Coupler for MTE, (.570"L)

Cartridge Drain Solenoid Valve



48-190

256-0548

256-0555

48-196

48-222

- 48-190** - Cartridge drain solenoid valve. Replaces Maxon 250072 and Leyman. *Single terminal.*
- 256-0548** - Cartridge drain valve
- 48-192** - Coil only, single terminal
- 256-0555** - Coil only, two terminal

- 48-196** - Cartridge Drain Solenoid Valve less block. Found on Waltco, Thieman, Anthony, Leyman (LH00094) & others.
- 155-0804** - Valve Only
- 48-197** - Coil only

- 48-221** - 4 Way Solenoid Valve *One terminal*
- 48-222** - 4-Way Solenoid Valve *Two terminals*
- 48-223** - Coil only, single terminal
- 48-224** - Coil only, two terminal

Breather Caps



48-183

- 48-181** - Breather Cap, Fenner power pack
- 48-183** - Breather Cap, Monarch power pack

LIFT GATE